

DONAU 450x450 concava

Certificare parte terta
Third Party Certification

Asigurarea calitatii
Quality Assurance



ISO 9001-2000

Norm
Standard
**DIN
EN124**



Klasse
Class
D400

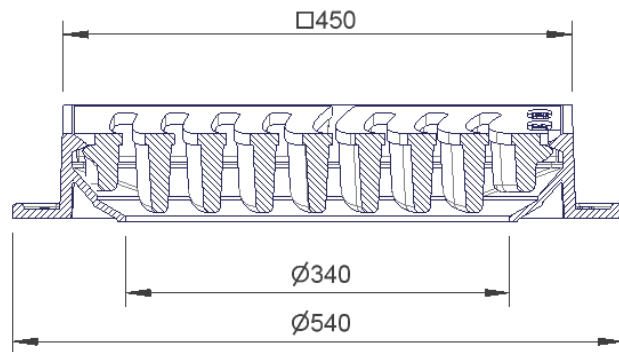
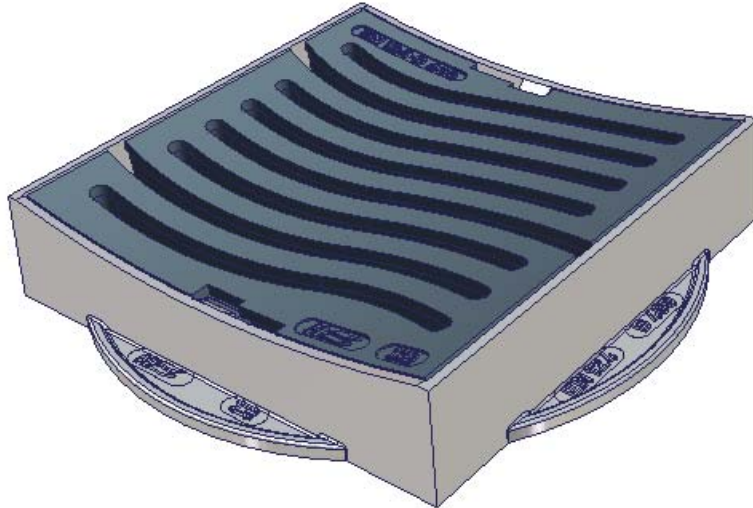

Sistem inchidere

- inchidere tip arc / "click elastic"
- sistem inchidere in 2 puncte
- sistem auto-inchidere

Rama

- tip flansa in 3 parti
- suport pentru cos aluviuni conform standardului DIN 4052-B1
- pentru camine DN 450

Alternativa

- in varianta plata (cod 994731)

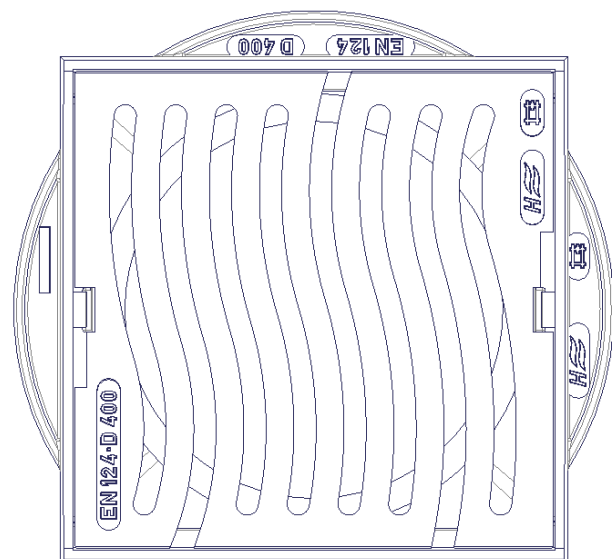

Änderungen vorbehalten! / subject to alterations in measurement and design!

Cod
Reference
994 741

Clasa de sarcina
Class
D 400

Material
Material
EN-GJS-500-7

Greutate
Weight
ca. 56 kg

A005-193

Schutzvermerk nach DIN 34 beachten!